

### Coning Detail

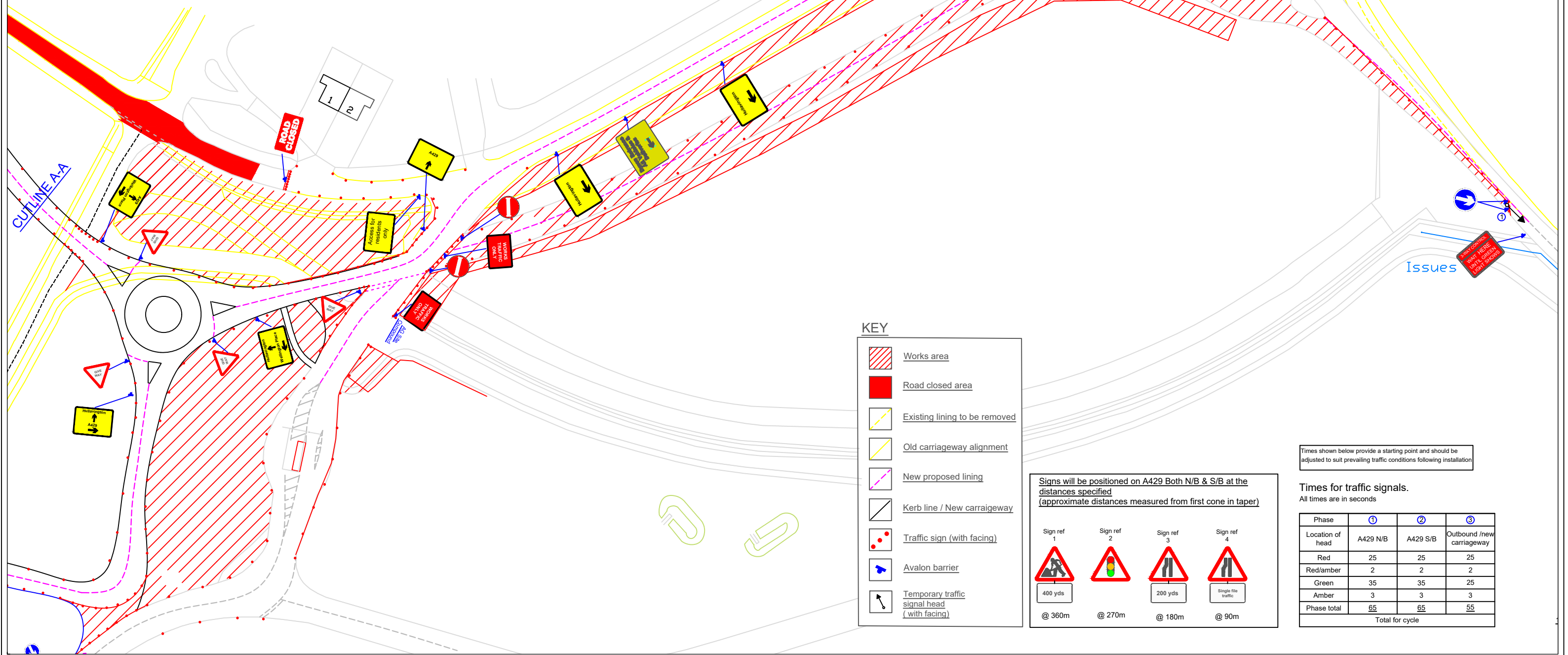
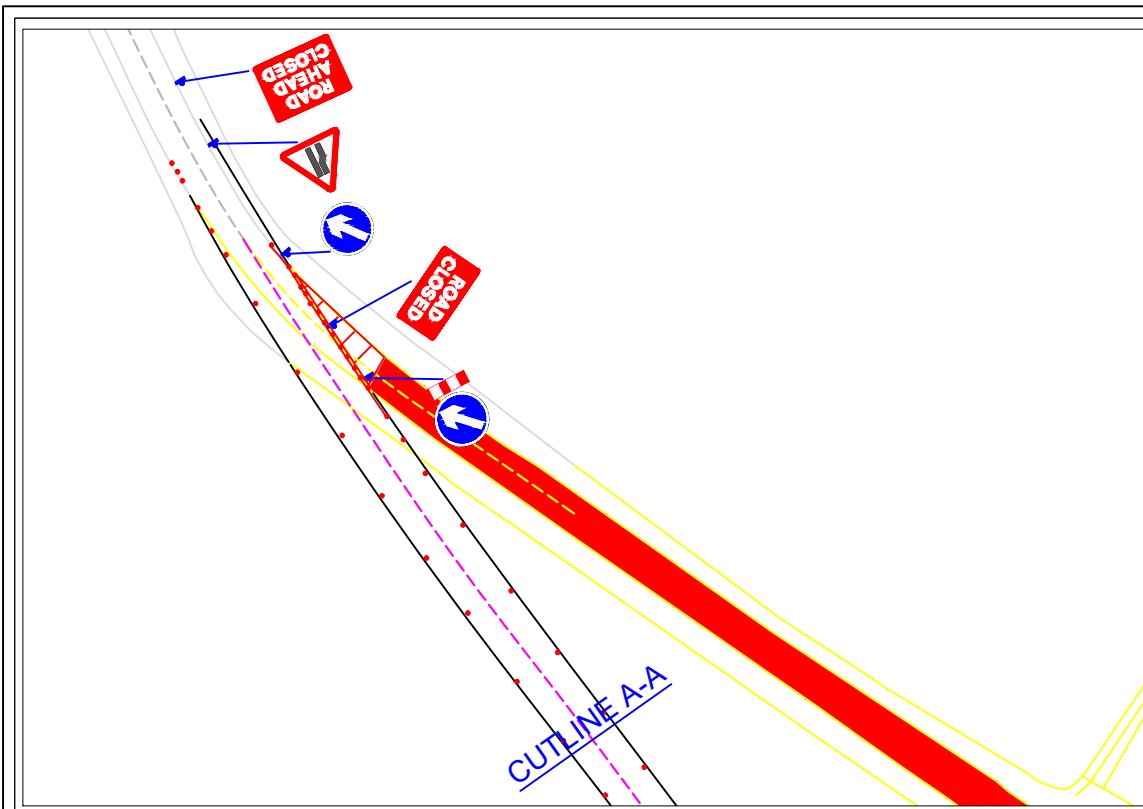
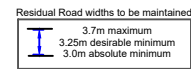
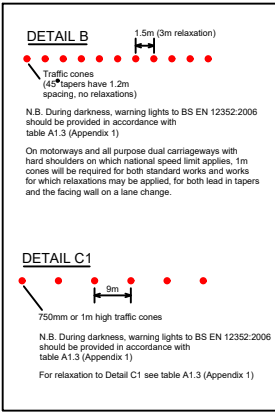

**KEY**

- Works area
- Road closed area
- Existing lining to be removed
- Old carriageway alignment
- New proposed lining
- Kerb line / New carriageway
- Traffic sign (with facing)
- Avalon barrier
- Temporary traffic signal head (with facing)

Signs will be positioned on A429 Both N/B & S/B at the distances specified (approximate distances measured from first cone in taper)

Sign ref	Sign ref	Sign ref	Sign ref
1	2	3	4
400 yds		200 yds	Single file traffic
@ 360m	@ 270m	@ 180m	@ 90m

Times shown below provide a starting point and should be adjusted to suit prevailing traffic conditions following installation

**Times for traffic signals.**  
 All times are in seconds

Phase	①	②	③
Location of head	A429 N/B	A429 S/B	Outbound / new carriageway
Red	25	25	25
Red/amber	2	2	2
Green	35	35	25
Amber	3	3	3
Phase total	65	65	55
Total for cycle			