

R:\EATS\Sec_L\15\Schemes\Tiverton LSO\Tiverton EUE Access Routes\DCC Design 4\SCH\EM DRAWINGS\C11017-53 Phase 1 extents.dwg - 18/05/2017 11:39:54 - Phase 1 extents - Anette.

Phase 1 - Work extends only to the section within the pink boundary and will be constructed from the A361

Roads A4 FRAME bottom box - Version 2.0

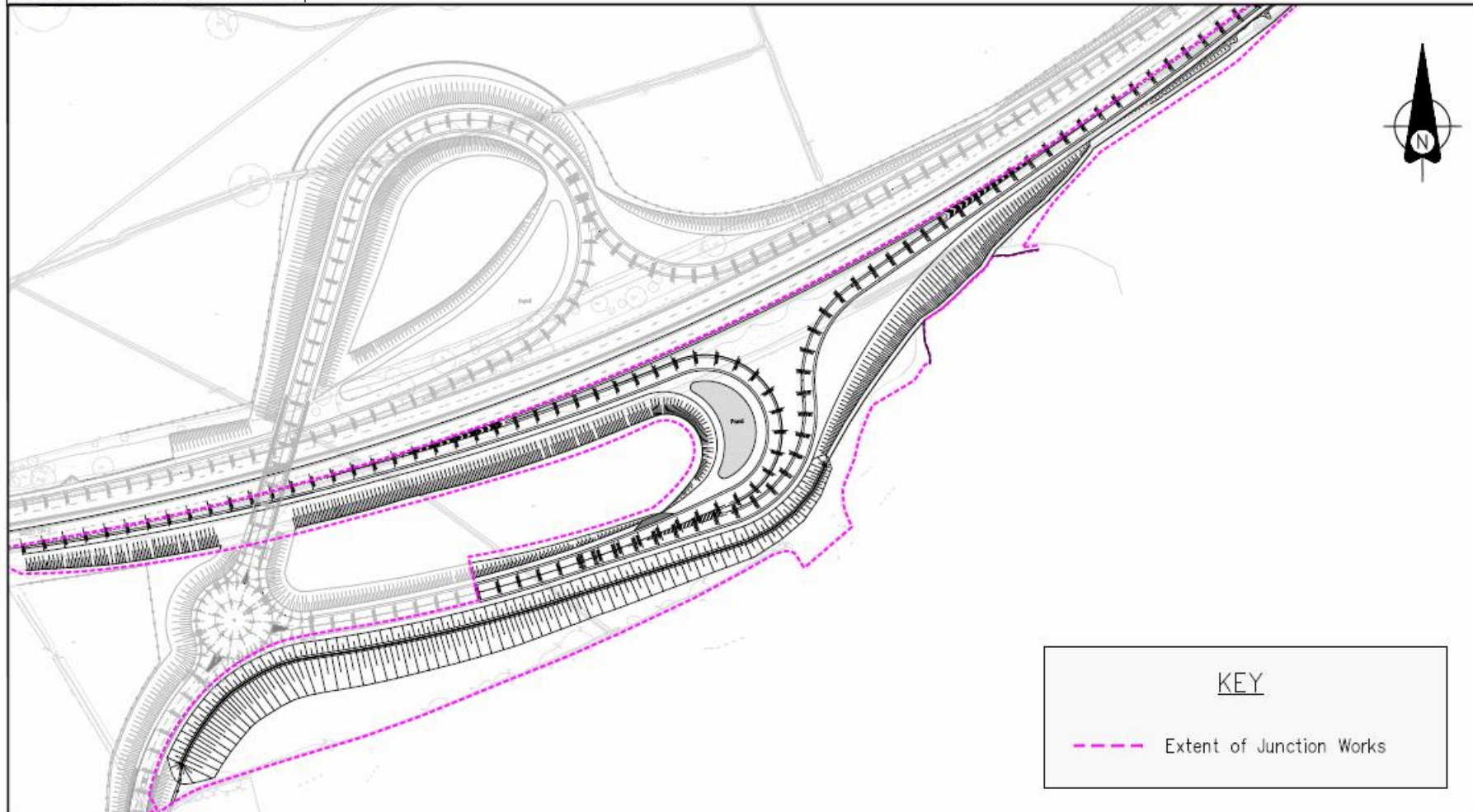

KEY

- - - - - Extent of Junction Works

Engineering Design Group

Devon County Council

Matford Offices Tel: 0845 155 1004
 County Hall Fax: 01392 382342
 Topsham Road
 Exeter customer@devon.gov.uk
 EX2 4QD www.devon.gov.uk

DRAWING TITLE

**A361 NORTH DEVON LINK
 TIVERTON
 EASTERN URBAN EXTENSION
 PHASE 1 EXTENTS**

Rev	Date	Drawn	Revisions	Chk
0	18.05.2017	AS		

Do not scale from this drawing in either hard or electronic format. No responsibility is accepted where this drawing is used in circumstances other than that for which it was originally prepared and issued.

Drawing number	C11017/53	Revision	0
Scale	NTS	Size	A4